

COMMERCIAL LEASE APPLICATION FORM

Thank you for your interest in Asteria Melaka @ Kota Laksamana, Melaka.

All requests for retail space must be submitted in writing. Upon receipt, your application will be reviewed for compatibility with our permanent tenant merchandise mix and, if approved, will be subject to space availability.



www.asteria.my

APPLICANT INFORMATION

Title Mr Miss Dr Dato Datin Tan Sri Puan Sri

Full Name

Contact Number (Office) _____ **(Mobile)** _____

Email Address

Mailing Address

BUSINESS INFORMATION

Trade Name

Company Name

Company Registration No.

Nature of Business

Registered Address

Website (if applicable)

Current Outlets/Branches

Type of Business Organization Sole Proprietorship Franchise
 Partnership Others, please specify _____

Demised Premises - Provisional Floor Area Ground Floor First Floor

Provisional Lot No.

Area/Size Requirement (approximate range)

Proposed Rental

Proposed Commencement Date

Additional Requirements

DISCLAIMER

I certify that all the above information is true and correct to the best of my knowledge that this form given to me is only for the purpose of applying for retail space. This is not considered as a lease agreement or contract.

Signature of Applicant

Date of Application

Name :
Designation :

Note: Please submit the following with this application form:-

- i. Company Profile
- ii. Company Proposal

Asteria Melaka

Suite 02-01, Level 2, Wisma Teras Eco,
No.56, Jalan Setia Tropika 1/14,
Taman Setia Tropika, 81200 Johor Bahru, Johor.
T: +607-213 3450
E: sales@asteria.my



ASTERIA
MELAKA

44 Storey
Serviced Apartment
306 Units

Shop A &
Shop B
(4 Storey)

Commercial Hub

GROUND FLOOR SITE PLAN

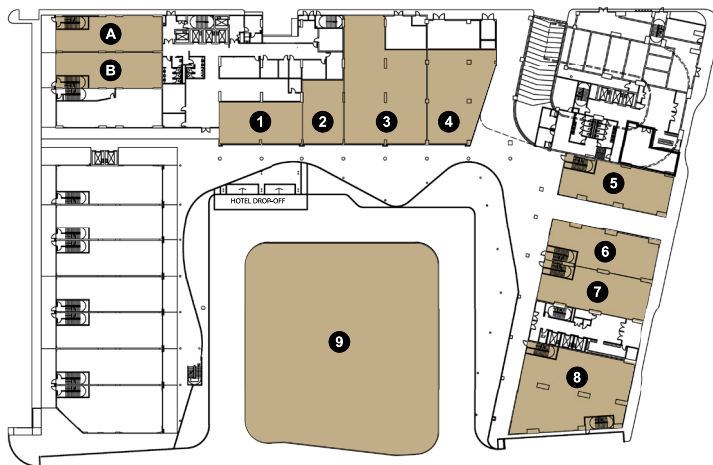

- A** Shop A : 5,619 sqft (4 Storey)
- B** Shop B : 5,339 sqft (4 Storey)
- 1** Retail 1 : 1,528 sqft
- 2** Retail 2 : 1,163 sqft
- 3** Retail 3 : 4,080 sqft
- 4** Retail 4 : 2,411 sqft
- 5** Retail 5 : 1,938 sqft
- 6** Retail 6 : 1,938 sqft
- 7** Retail 7 : 1,938 sqft
- 8** Retail 8 : 3,670 sqft
- 9** Retail 9 : 16,000 sqft

FIRST FLOOR SITE PLAN



- 11** Retail 11 : 1,550 sqft
- 12** Retail 12 : 1,550 sqft
- 13** Retail 13 : 1,550 sqft
- 14** Retail 14 : 2,131 sqft
- 15** Retail 15 : 3,961 sqft
- 16** Retail 16 : 2,486 sqft
- 17** Retail 17 : 2,486 sqft
- 18** Retail 18 : 4,779 sqft